

PERMIT # \_\_\_\_\_

# DECK PERMIT APPLICATION

SECTION 1211.04 (b)



CITY OF WESTLAKE  
BUILDING DEPARTMENT  
27700 HILLIARD BLVD.  
WESTLAKE, OHIO 44145  
PHONE (440) 617-4105  
FAX (440) 617-4144

### OFFICE USE ONLY

APPROVED BY: \_\_\_\_\_

DATE APPROVED: \_\_\_\_\_

DATE ISSUED: \_\_\_\_\_

DECK PERMIT: \$ 25.00

PLAN REVIEW: \$ 5.00

1% B.B.S. \$ 0.30

**TOTAL: \$ 30.30**

**INCOMPLETE APPLICATIONS WILL DELAY PERMIT PROCESSING**

#### PROPERTY/OWNER INFORMATION

NAME: \_\_\_\_\_

ADDRESS: \_\_\_\_\_

PHONE: \_\_\_\_\_

APPLICATION DATE: \_\_\_\_\_

ESTIMATED COST: \_\_\_\_\_

CHECK BOX IF CORNER LOT  
(Other requirements apply)

#### CONTRACTOR/INSTALLER INFORMATION

Not required if owner is performing ALL work

COMPANY NAME: \_\_\_\_\_

EMAIL: \_\_\_\_\_

CONTACT PERSON: \_\_\_\_\_

CONTACT PHONE: \_\_\_\_\_

**NOTICE TO CONTRACTORS:  
FAILURE TO CALL FOR INSPECTIONS MAY RESULT  
IN LOSS OF REGISTRATION.**

SEE ATTACHED :

RESIDENTIAL DECK SUBMITTAL CHECKLIST AND **REQUIRED INSPECTIONS**

DECK SITE PLAN REQUIREMENTS

RESIDENTIAL WOOD DECK CONSTRUCTION INFORMATION

MINIMUM FOOTER SIZE CHART

POST AND HEADER PLAN REQUIREMENTS

TYPICAL DECK SECTION

#### RESIDENTIAL DECK

- \* Minimum 36 inch depth required for postholes.
- \* Width of stairways shall not be less than 36" at all points.
- \* Maximum riser height of steps shall be 8-1/4".
- \* Minimum tread (depth) of steps shall be 9" min. with nose.
- \* Guardrails shall be installed if deck is 30" or more above grade.
- \* Spindle Space on guardrails / handrails shall be 4" or less.

#### GENERAL INFORMATION

- \* Minimum height of handrail shall be 34".
- \* Maximum height of handrail shall be 38".
- \* Call 24 hours in advance for posthole and Final inspections (440) 617-4105.
- \* Other requirements apply for corner lots.
- \* Minimum height of guardrails shall be 36"

**OWNER/CONTRACTOR** \_\_\_\_\_ **PRINT NAME** \_\_\_\_\_

**The Westlake Building Department does not enforce deed restrictions, covenants, or subdivision regulations.**

The acceptance of the permit herein applied for shall constitute an agreement on my part to abide by all conditions herein contained and also to comply with all ordinances set forth by the City of Westlake, and the laws of the State of Ohio relating to the work to be done thereunder and said agreement is a condition of said permit.

***IMPORTANT NOTICE TO HOMEOWNERS:***

**IF YOU OBTAIN THIS PERMIT ON THE BEHALF OF A CONTRACTOR YOU ARE LIABLE FOR ALL WORK INCLUDING ANY VIOLATIONS OR INCOMPLETE WORK.  
CONTRACTORS MUST BE CURRENTLY REGISTERED WITH THE CITY OF WESTLAKE.**



**BUILDING DEPARTMENT**

27700 Hilliard Blvd.  
Westlake, OH 44145

Phone 440.617.4105  
Fax 440.617.4144

**RESIDENTIAL DECK SUBMITTAL CHECKLIST**

**Address** \_\_\_\_\_

**Owner** \_\_\_\_\_

**Contractor** \_\_\_\_\_

**Contact Name** \_\_\_\_\_

**Contact Email** \_\_\_\_\_

Completed Deck Application / Indicate if Corner Lot	
2 Sets of Construction Plan drawings	
2 Copies of Topo or Site Plan indicating distances to all property lines, exact location and dimensions of proposed deck and steps	
Letter of approval from Condominium Association (If applicable)	
<b>Construction Plans Should Include:</b>	
All deck dimensions, post & beam layout, and house wall cantilevers (Down-view)	
Height of deck above grade	
Beam size and spacing	
Post size and spacing	
Joist size and spacing	
Beam connection to posts	
Joist connections to ledger and beam	
Ledger attachment to house and flashing	
Footing size, depth and method	
Floor framing plan indicating framing member sizes and spacing	
Connections of all structural members	
Size and type of decking material (pressure treated wood, vinyl, etc.)	
Height, size, type an spacing of guardrail posts and balusters	
Stair Tread (Width) and Riser Details (Height) of Steps	
<b>Test to determine if plans are complete:</b>	
Could someone else build your deck from the plans you are submitting?	
<b>REQUIRED INSPECTIONS / SCHEDULED 24 HOURS IN ADVANCE:</b>	
Footer (Post Holes) <b>before</b> posts are in place and concrete is poured	
Frame prior to installing flooring and railings	
Final when Deck is completed	

# TYPICAL DECK SITE PLAN

PROVIDE THE FOLLOWING:

- \*LOT DEMENSIONS (LENGTH AND WIDTH)
- \*PROPOSED SIDE AND REAR (OR FRONT) YARD SETBACKS
- \*DECK DIMENSIONS
- \*STATE IF CORNER LOT – RESTRICTIONS APPLY

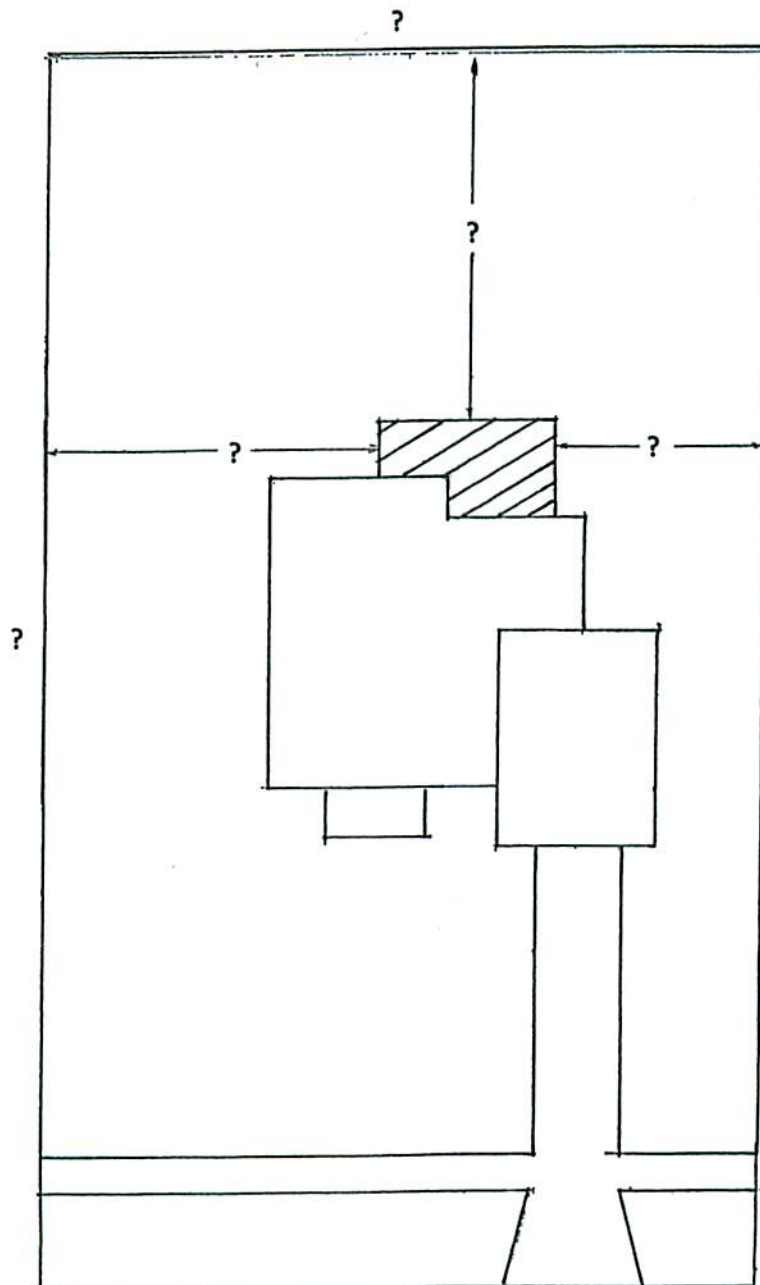

## **Residential Wood Deck Construction**

**Based on 2019 Residential Code of Ohio**

This sheet provides some applicable building code information for deck construction, but does not cover unique or non-typical conditions which may create unusual design requirements (i.e. loading in excess of 50 PSF, unusual site conditions, etc.). When these situations are encountered **a licensed architect or engineer may be required for your design. Examples of some of these situations include:**

- \*Decks serving more than a one and two family dwelling**
- \*Decks including more than one level or roofs**
- \*Decks supporting hot tubs, spas, or other objects**
- \*Decks greater than 10' above grade**
- \*Deck ledgers attached to overhangs, bay windows, brick, stone or concrete block**
- \*Decks on slopes greater than 2 horizontal to 1 vertical.**

The following code sections from the Residential Code of Ohio should be used when designing and building your deck:

Section 507.3 Deck Footings

Section 317 Protection of wood & wood products against decay

Section 507 Exterior Decks

Sections 311 & 312 Stair, landings, handrails, and guards.

**\*Decks shall be designed for 50 PSF uniform loading and shall be built of material which is pressure treated or naturally resistant to decay. Posts and applicable 2 x material shall be ground-contact treated wood.**

**\*Fasteners, hangers, nails, etc., must be stainless steel, hot-dipped galvanized, silicon bronze or copper (see RCO for additional information).**

**\*Ledger Board attachment shall be per charts located in section 502 or per manufacturer's installation specifications.**

As an alternate to designing a deck prescriptively per the Residential Code of Ohio, one may use the DCA-6 Prescriptive Residential Deck Construction Guide (by the American Wood council) or an engineered design.

**\*See attachments detailing submission requirements for applications and plans\***

**TABLE 403.5**  
**MINIMUM FOOTING SIZE FOR DECK FOOTINGS WITHOUT ROOF LOADS**  
**EXTERIOR DECK AND PORCH FOOTING SIZE IN INCHES<sup>a,b</sup>**

Diameter	Square	Maximum Tributary Area Allowed Per Post (square feet)
8	8 x 8	14
10	9 x 9	22
12	11 x 11	31.6
14	13 x 13	42.8
16	15 x 15	56
18	16 x 16	70.8
20	18 x 18	87.2

- a. Based upon 2000 lbs. per square foot soil bearing capacity.
- b. Based upon 40 lbs. per square foot live load and a 10 lbs. per square foot dead load.

**MINIMUM FOOTER SIZE CHART**

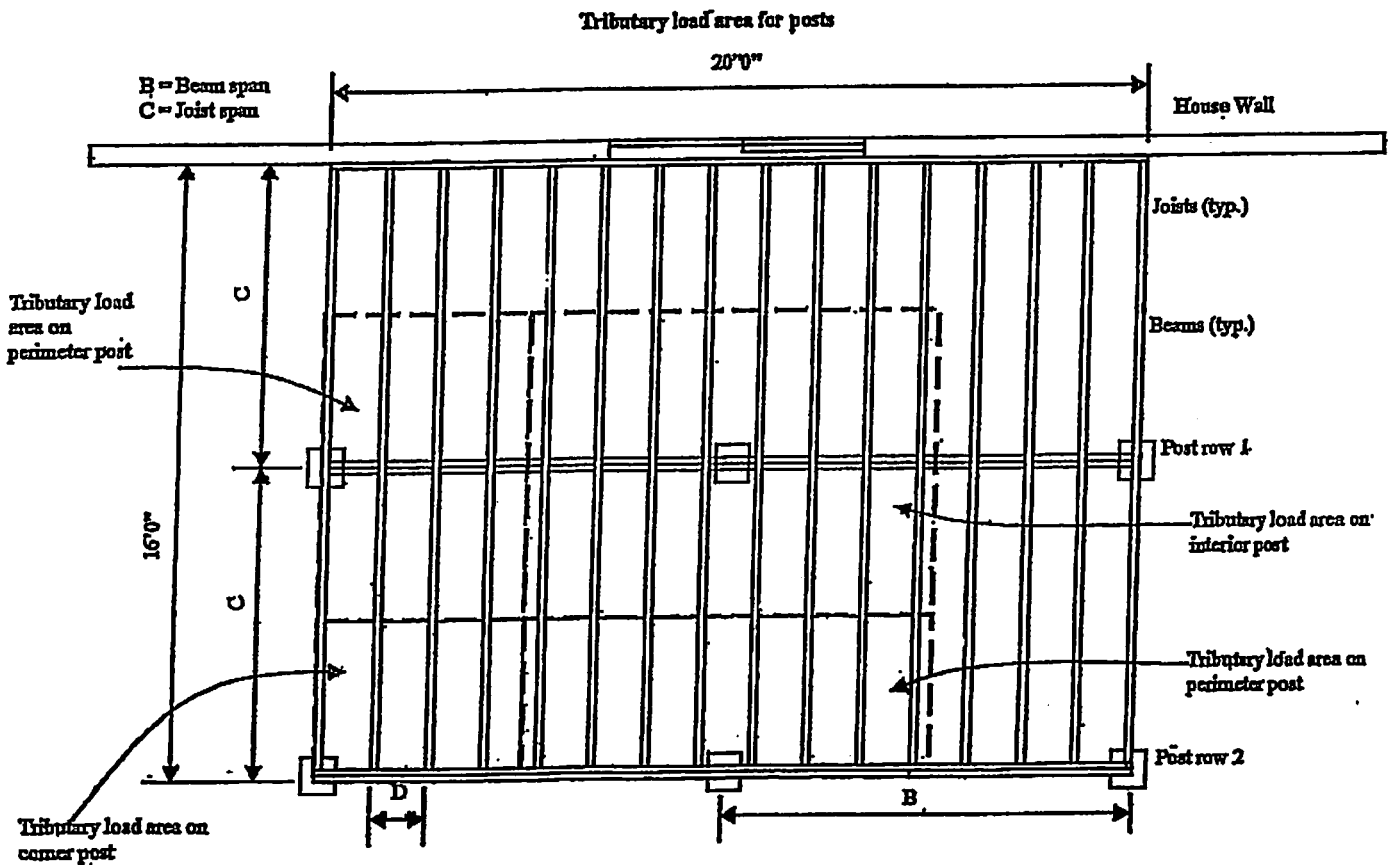

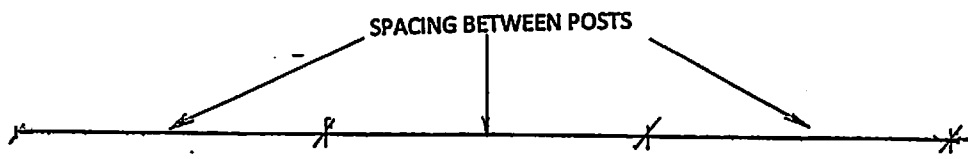

LEDGER ATTACHMENT TO HOUSE

JOIST SIZE AND SPACING

POST AND FOOTER SIZE

BEAM AND JOIST OVERHANGS

SIZE AND SPACING BETWEEN BEAMS

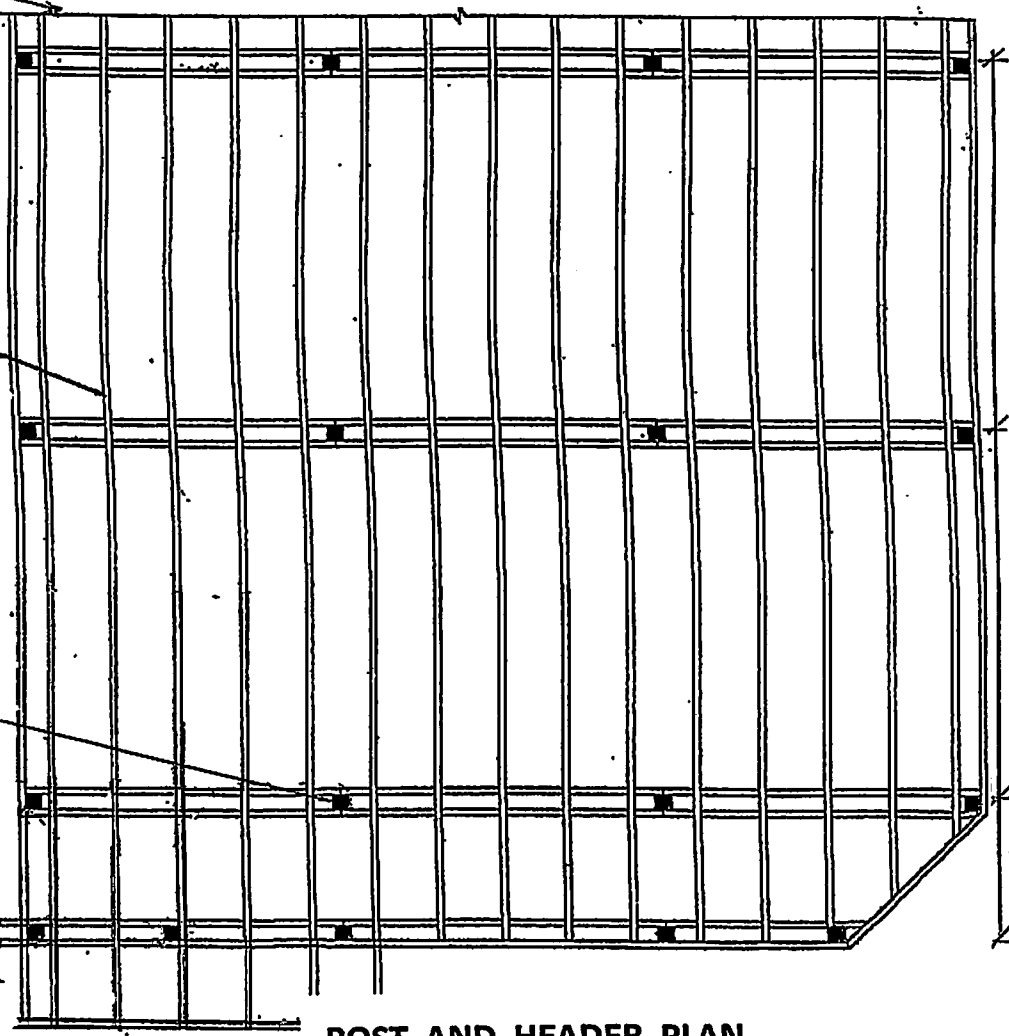

**POST AND HEADER PLAN**

ITEMS REQUIRED ON DRAWINGS

# TYPICAL DECK SECTION

## CHECK LIST

- Exterior wood will be naturally durable or quality mark as pressure-preservative-treated in accordance with AWPA U1.
- Fasteners will be hot dipped zinc-coated galvanized steel, stainless steel, silicon bronze or copper.
- 36" minimum Guard will be provided along open-sides of deck walking surface located 30" or more above Grade below.
- 4" Sphere will not pass thru any guard openings.

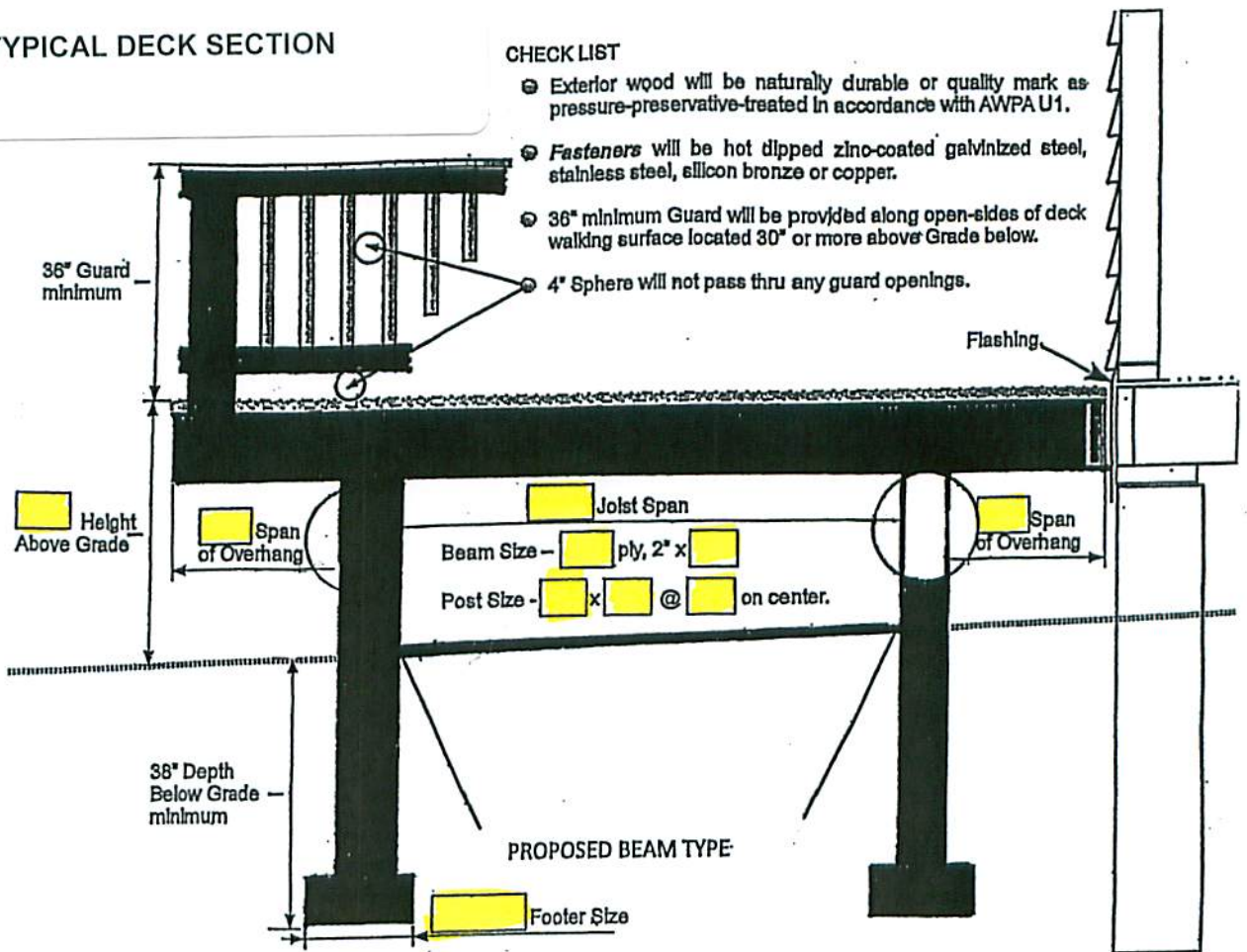

## Beam to Post Connection Options

[ ] Choose one beam to post connection option.

Choose one post size based on the height of the deck.

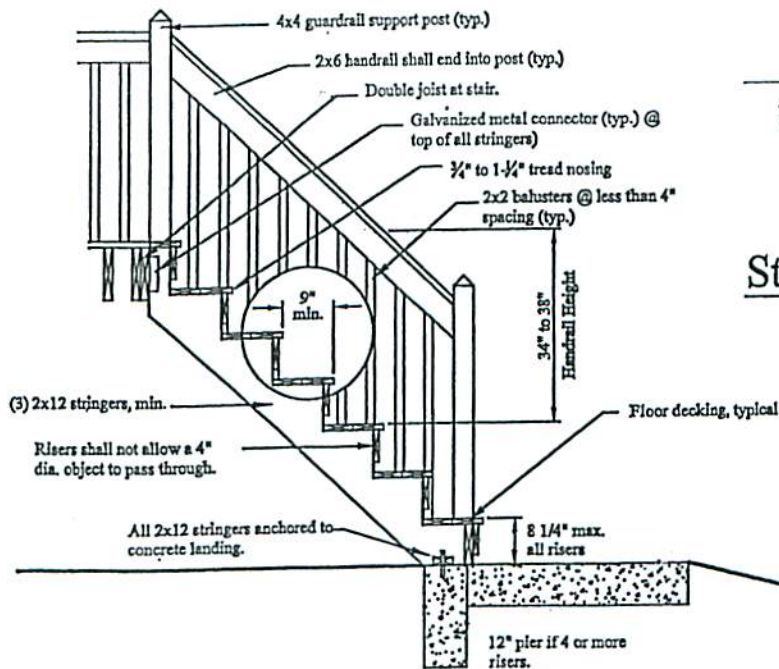
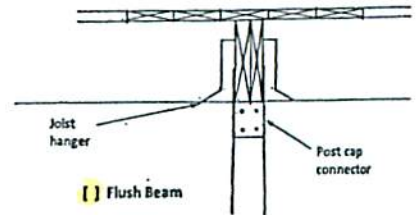
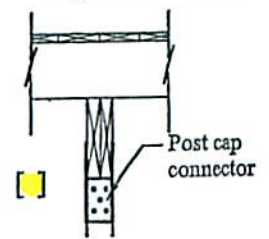
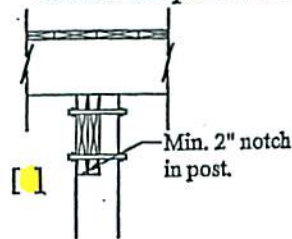
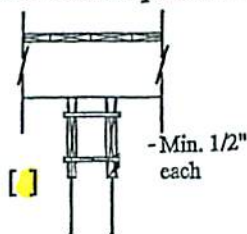

## Stair Section View